

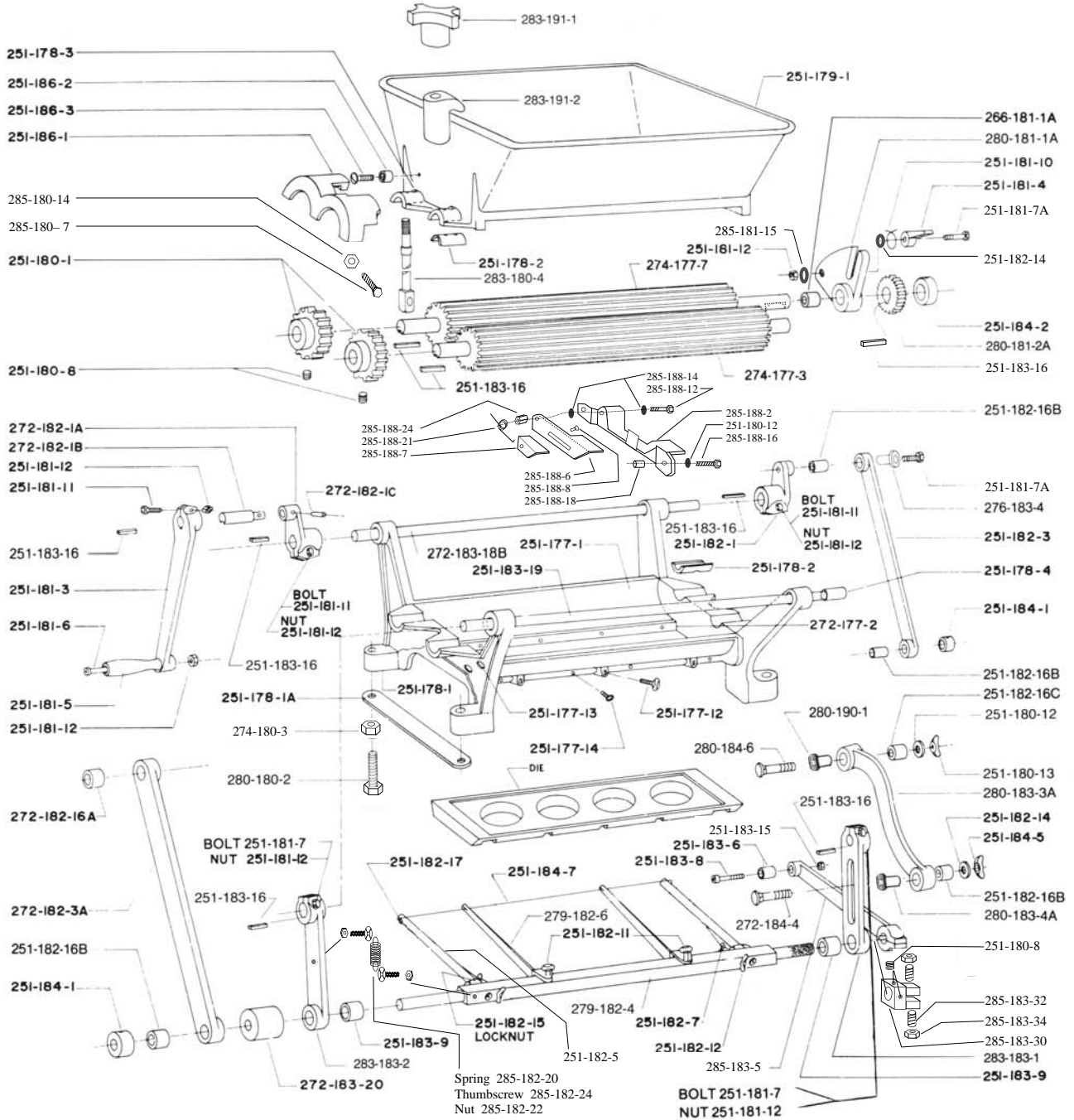

Benchtop Depositing Head Parts Diagram



Practical Baker, 1001 West Diggins Street, Harvard, IL 60033 USA
 (815) 943-6040 Phone (815) 943-9077 Fax www.Kook-e-King.com

Benchtop	Part Number	Part Description
	2 251-177- 1	Side Plate - Requires Machine Shop Fit
	6 251-177-12	Die Support Thumb Screw
	8 251-177-13	End Plate Bolt Allen Drive
	8 251-177-14	Scrapper Screw for Machines after 762518 (3/4" Long)
	4 251-177-15	Roll Pin for Sides / Ends
	2 251-178- 1	End Frame - Requires Machine Shop Fit
	2 251-178- 1A	Aluminum Guard Strip on Feet
	8 251-178- 2	Roll Shaft Split Bushing Brass
	8 251-178- 3	Screw for Split Bushings at Feed Rollers (Brass)
	4 251-178- 4	Bushing Brass where Shafts meet End Frames
	1 251-179- 1	Hopper - May Require Machine Shop Fit
	2 251-180- 1	Spur Gear that drives Feed Rollers, Alum 28 Teeth
	6 251-180- 8	Set Screw for Alum Spur Gears (2per), Adjustable Arm Receiver (2)
	3 251-180-12	Washer- Cam to Frame; Rat. Plate Flange to "S" Bar Top
	1 251-180-13	Wing Nut for Ratchet Plate Flange
	1 251-181- 3	Crank Arm Only; No Handle or Crank Knuckle
	1 251-181- 4	Ratchet Pawl, (on Ratchet Plate, Engages Ratchet Gear)
	1 251-181- 5	Crank Handle Only
	1 251-181- 6	4" Long Bolt - For Crank Handle to Arm
	2 251-181- 7	Bolt- Rocker Arms
	2 251-181- 7A	Bolt - Ratchet Plate, Long Con Rod to Knuckle, Sprocket to Long Con Rod (Auto)
	1 251-181-10	Pawl Spring - Hold Ratchet Pawl tight to Ratchet Gear
	3 251-181-11	Bolt - Crank Knuckles, Crank Arm
	7 251-181-12	Jam Nut-Ratchet Plate, Crank Knuckles, Crank Arm, Crank Handle, Rocker Arms
	1 251-182- 1	Crank Knuckle, Non-Cranking (Ratchet Plate) Side
	1 251-182- 3	Long Con Rod with Bushings (2) 251-182-16B- Non-Cranking Side
	2 251-182- 5	Wire Carrier SS Bar for Wire Asmbly
	2 251-182- 7	Thumb Screw to Attach Wire to Square Bar
	3 251-182-11	Thumb Screw for Wire Support Finger
	2 251-182-12	Wingnut for Cutoff Wire Thumb Screw
	2 251-182-14	Washer - Rocker Arm Washer to "S" Bar Bottom & Between Ratchet & Pawl
	2 251-182-15	Lock Nut for Wire Carrier Rod
	4 251-182-16B	Bushing Bronze for Long Con Rods & S Bar
	1 251-182-16C	Bushing Bronze "S" Bar Top End
	2 251-182-17	Screw at End of Wire Carrier Rod
	1 251-183- 6	Nylon Roller for Wire Lift Arm
	1 251-183- 8	Bolt to hold Nylon Roller to Wire Lift Arm
	2 251-183- 9	Rocker Arm Bushing
	1 251-183-15	Nylock , for Lift Arm/Roller Asmbly
	8 251-183-16	Rectangular Key used in Several Places
	1 251-183-19	Shaft SS Counter (Front)
	2 251-184- 1	Set Collar for Square Bar 5/8"
	1 251-184- 2	Set Collar for Ratchet Plate 3/4" & Back Shaft on A & SA
	1 251-184- 5	Wing Nut for Rocker Arm Flang (Bottom of S Bar)
	1 251-184- 7x	Cut off Wire with Thumb Screws & Wing Nuts Assembly
	1 251-186- 1	Guard for Double Spur Gears
	2 251-186- 2	Sleeve for Gear Guard Bolts
	2 251-186- 3	Gear Guard Bolt
	251-186- 7	Roll of Cut Off Wire
	1 266-181- 1A	Bushing Brass - Ratchet Plate (Included in 280-181-1A)
	2 272-177- 2	Scrapper for Machines after 762518
	1 272-182- 1A	Crank Knuckle; Cranking Side (Large Hole)
	272-182- 1Ax	Crank Knuckle Asmbly - with Shaft 182-1B & Pin 182-1C
	1 272-182- 1B	Shaft Short for Crank and Knuckle
	1 272-182- 1C	Steal Pin; used in 272-182-1A Crank Knuckle Asmbly
	1 272-182- 3A	Long Con Rod with Bushings 281-16A & 281-16B -Cranking Side

Benchtop	Part Number	Part Description
1	272-182-16A	Bushing Bronze for Top Long Con Rod, Cranking Side
1	272-183-18B	Shaft SS Drive (Back)
1	272-183-20	Spacer Aluminum - on Square Wire Lift Bar
1	272-184- 4	Bolt for Rocker Arm Flange (Bottom of S Bar)
1	274-177- 3	Feed Roller Complete with Spur Gear Shaft & Short Plain Shaft
1	274-177- 7	Feed Roller Complete with Spur Gear Shaft & Long Shaft for Ratchet Gear/Plate
4	274-180- 3	Hex Nut for Foot Screws
1	276-183- 4	Brass Flange - No grooves; Top of Long Con Rod Non-crank Side
1	279-182- 4	Square Bar Only SS, (Holds Rods, Fingers, Cutoff Wire-assembly)
3	279-182- 6	Wire Support Finger
	279-182- 6x	Wire Support Finger with Thumb Screw
4	280-180- 2	Hex Foot Screw for Benchtop (3")
1	280-181- 1A	Ratchet Plate with Bushing (266-181-1A)
1	280-181- 2A	Ratchet Gear - 2 1/4" Diam - 42 Tooth
1	280-183- 3A	Short "S" Connecting Rod with Bushings 182-16C & 281-16B
1	280-183- 4A	Rocker Arm Flange with Grooves, Large Hole; Bottom of S Bar
1	280-184- 6	Bolt for Ratchet Plate Flange at Top of S Bar
1	280-190- 1	Ratchet Plate Flange, Grooved, Small Hole (Top Side of S Bar to Ratchet Plate)
2	283-180- 4	Hopper Eye Bolt for Machines with Hooks Over Hopper
1	283-183- 1	Slotted Rocker Arm (includes 183-9 Bushing)
1	283-183- 2	Plain Rocker Arm (includes 183-9 Bushing)
2	283-191- 1	Hopper Knob
2	283-191- 2	Hopper Hook for Hopper Eye Bolt
2	285-180- 7	Screw - Hopper Eye Bolt to End Frame
2	285-180-14	Nylock - Hopper Eye Bolt to End Frame
1	285-181-15	Washer- Back Side of Ratched Plate
1	285-182-20	Spring - for Tension on Square Bar
2	285-182-22	Jam Nut - for Tension on Square Bar
2	285-182-24	Thumb Screw - Holds Spring to Square Bar and to Rocker Arm
1	285-183- 5	Wire Lift Arm Adjustable
	285-183- 5x	Wire Lift Arm Adjustable Assembly w/Roller and Roller Hardware
1	285-183-30	Wire Lift Arm Receiver
2	285-183-32	Set Screw for Wire Lift Arm Receiver
2	285-183-34	Hex Nut for Wire Lift Arm Receiver
1	285-188- 2	Cam Bracket - for Adjustable Cam
1	285-188- 6	Wire Lift Dog - for Adjustable Cam
1	285-188- 7	Wire Lift Dog Slider - for Adjustable Cam
1	285-188- 8	Button Head Socket Screw - Holds Wire Lift Dog to Slider
1	285-188-12	Shoulder Bolt for Adj Cam Hinge
2	285-188-14	Nylon Flat Washer for Adj Cam Hinge
2	285-188-16	Screw for Adj Cam to End Frame
2	285-188-18	Cam Spacer for Adj Cam to End Frame
1	285-188-21	Cam Spring V2 - Mounts to Adj Cam Hinge
1	285-188-24	Coupler Nut for Adj Cam Hinge